

**BRIDGE WITH CURBS ONLY
DECK SECTION W/STRINGERS @2'-0" O.C.**

* MINIMUM NUMBER OF STRINGERS IS THREE.
SCALE: 1" = 1'-0"
RA850A3

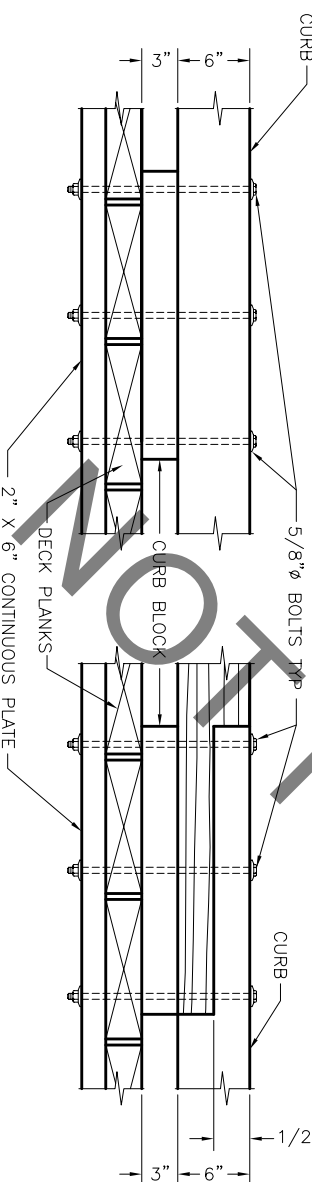
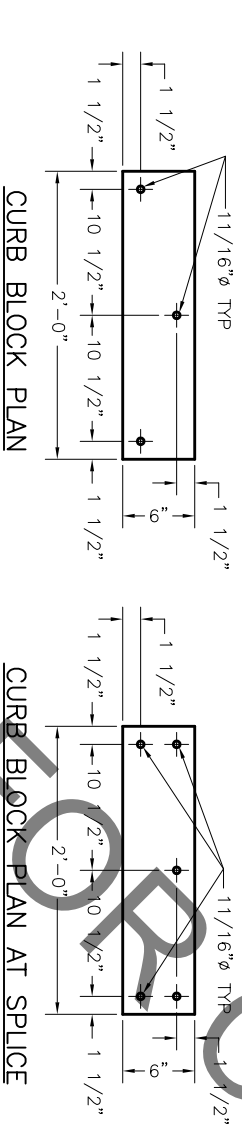

GENERAL NOTES:

SPECIFICATIONS: MATERIALS AND CONSTRUCTION OF THIS STRUCTURE SHALL BE IN ACCORDANCE WITH THE CURRENTLY ADOPTED USDA FOREST SERVICE SPECIFICATIONS FOR CONSTRUCTION OF ROADS AND BRIDGES, AS MODIFIED FOR THIS CONTRACT.

TIMBER & LUMBER: SOLID SAWN TIMBER MEMBERS SHALL CONFORM TO THE REQUIREMENTS OF THE GRADING RULES AGENCY FOR THE SPECIES, TYPE, AND GRADE SPECIFIED BELOW.

STRINGERS, DECK PLANKS, CURBS, SILLS, & BACKING PLANKS
- COASTAL REGION DOUGLAS FIR-LARCH ROUGH SAWN No.1 GRADE, GRADING RULES AGENCY - WMPA, WCLB
- COASTAL REGION DOUGLAS FIR-LARCH ROUGH SAWN No.2 GRADE, GRADING RULES AGENCY - WMPA, WCLB

BRIDGE RAILS & POSTS (SEE PROJECT CRITERIA)

- REDWOOD, S4S, No.1 GRADE
- GRADING RULES AGENCY - RIS
- WESTERN RED CEDAR, S4S, SELECT STRUCTURAL GRADE
- GRADING RULES AGENCY - WMPA, WCLB
- HEM-FIR/DOUGLAS FIR, S4S, No.1 GRADE
- GRADING RULES AGENCY - WMPA, WCLB

TREATED

TREATMENT: SEE PROJECT CRITERIA FOR MEMBERS IDENTIFIED TO BE TREATED AND FOR TREATMENT TYPE. PRESERVATIVE TREATMENT SHALL BE IN ACCORDANCE WITH THE CURRENT AWPA SPECIFICATIONS USING THE TREATMENT MATERIALS LISTED BELOW. TREATMENT WILL COMPLY WITH THE REQUIREMENTS OF THE CURRENT EDITION OF WMPA'S "BEST MANAGEMENT PRACTICES FOR THE USE OF TREATED WOOD IN AQUATIC ENVIRONMENTS", SOLID SAWN LUMBER

BRIDGE RAILS & POSTS

- AWPA C2 (ABOVE GROUND USE)
- PENTACHLOROPHENOL IN LIGHT OIL (TYPE C SOLVENT)
- COPPER NAPHTHENATE IN HEAVY OIL (TYPE A SOLVENT)
- AWPA C2 (ABOVE GROUND USE)
- PENTACHLOROPHENOL IN LIGHT OIL (TYPE C SOLVENT)
- COPPER NAPHTHENATE IN HEAVY OIL (TYPE A SOLVENT)
- OXINE COPPER IN LIGHT OIL (TYPE C SOLVENT)
- ACZA, ACO

FIELD TREATMENT: COPPER NAPHTHENATE (2% SOLUTION) SHALL BE FURNISHED FOR FIELD TREATING OF WOOD. ALL ABRASIONS AND FIELD CUTS -APPROVED BY THE C.O.R.- SHALL BE CAREFULLY TRIMMED AND GIVEN THREE BRUSH COATS OF THE FIELD TREATMENT SOLUTION, WHERE APPROVED FIELD DRILLING OF BOLT OR NAIL HOLES IS REQUIRED. THE HOLES SHALL BE POURED FULL OF PRESERVATIVE PRIOR TO INSERTING THE FASTENERS. HARDWARE AND STRUCTURAL STEEL: SEE PROJECT DESIGN CRITERIA FOR STEEL

WHEN STRUCTURAL STEEL IS TO BE WELDED, THE WELDING PROCEDURE SHALL BE IN ACCORDANCE WITH AWS D1.1 AND SHALL BE SUITABLE FOR THE GRADE OF STEEL AND INTENDED USE.

FABRICATION: SUBMIT SHOP DRAWINGS FOR ALL BRIDGE COMPONENTS (EXCEPT TIMBER RUNNING PLANKS). SHOW ALL DIMENSIONS AND FABRICATION DETAILS FOR ALL CUT OR BORED TIMBER. FIELD DRILLING OF HOLES SHALL NOT BE ALLOWED UNLESS OTHERWISE NOTED ON THE PLANS.

RA850C3

**-REDUCED-
DO NOT SCALE DRAWING**

REV.	DESCRIPTION	APPROVED	DATE
Δ	REVISED TO R-6 STRUCTURES CAD STANDARDS	MOE	5/24/05

U.S. DEPARTMENT OF AGRICULTURE
FOREST SERVICE
THE PACIFIC NORTHWEST REGION (R-6)
SOLID SAWN TIMBER STRINGER
10 FT - 40 FT LONG
TRAIL BRIDGE

Forest Bridge No.:
Location:
Designed:
Drawn: LMcNEAL
Checked:
Approved: /s/ MERVIN O. ERIKSSON
REGIONAL BRIDGE ENGINEER
Date: 03/01/2004

APPROVED:

FOREST ENGINEER

DATE

DWG NO.

SHEET 3 of 4 DESIGN AND RA850

SCALE: 1'-1/2" = 1'-0"
RA850B3

ELEVATION
TYPICAL CONNECTION
ELEVATION
CONNECTION AT SPLICE
SOLID SAWN CURB CONNECTION DETAILS