

**PLAN**  
SCALE: 1/2" = 1'-0"

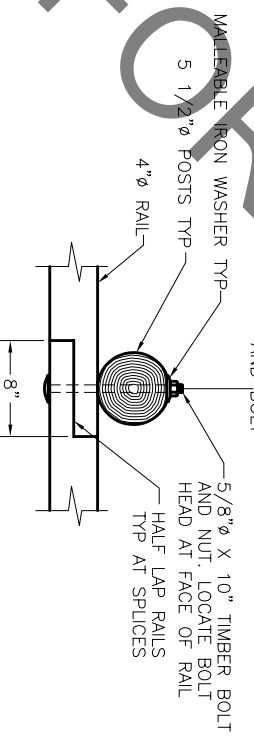

**ELEVATION**  
SCALE: 1/2" = 1'-0"

**SUPERSTRUCTURE**  
GRADE SHOWN AT 0.0%  
RA840A2



SCALE: 1 1/2" = 1'-0"

**NOTES:**

1. FASTEN DECK PLANKS TO STRINGERS WITH TWO ROWS 5/16" X 7" RING SHANK NAILS PER PLANK AT EACH STRINGER. ALTERNATE CENTERS.
2. SPLICE RAILS AT POSTS. RAILS SHALL BE CONTINUOUS FOR A MINIMUM OF TWO POST SPACES. ALTERNATE RAIL SPLICES AT POSTS.
3. FASTEN RUNNING PLANKS TO DECK WITH 40d (5" RING SHANK) NAILS AT 24" SPACING. ALTERNATE CENTERS WITH TWO AT EACH END.

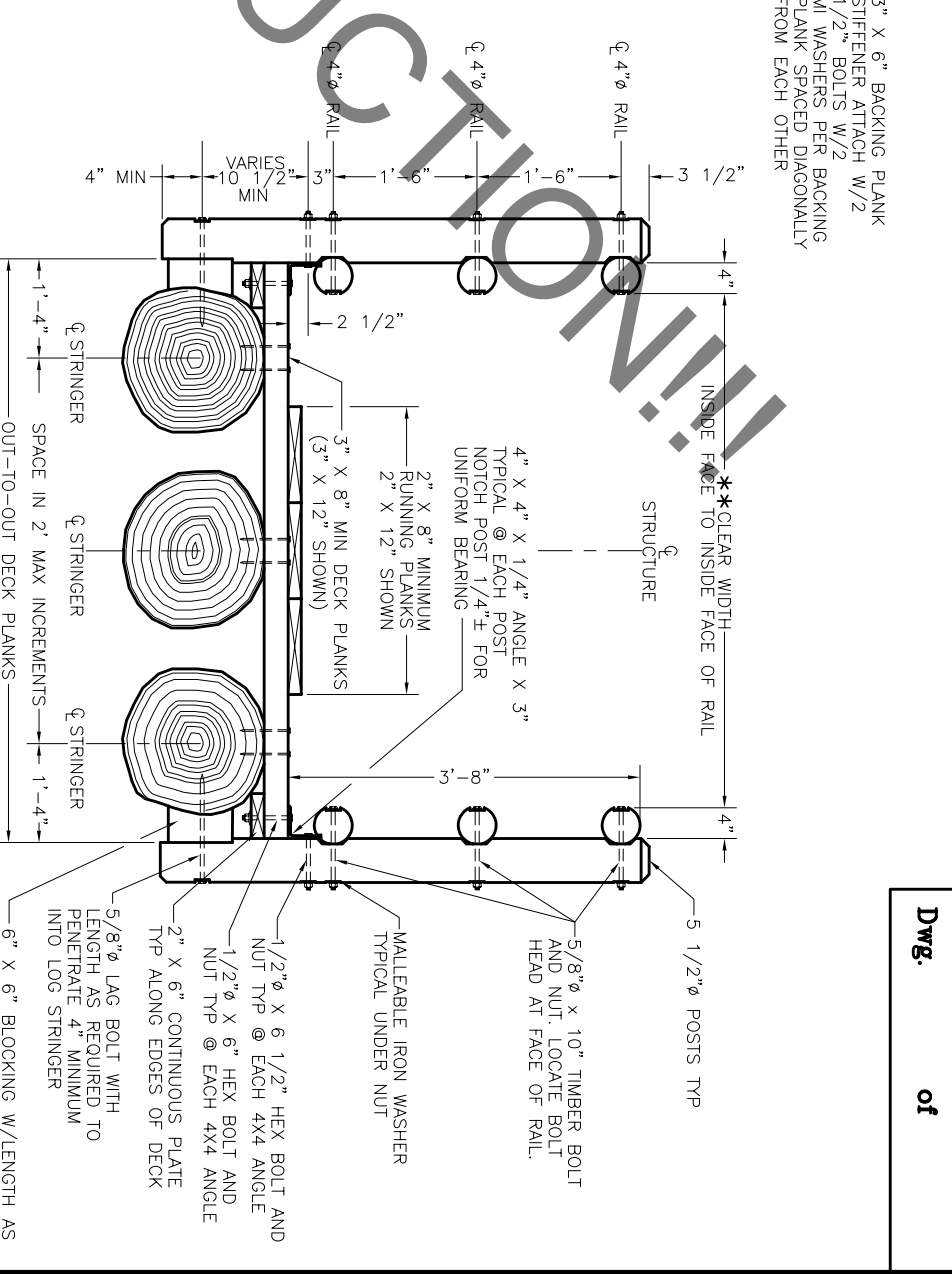

**DECK SECTION W/POLE HAND RAILS**  
SCALE: 1" = 1'-0"  
RA840B2

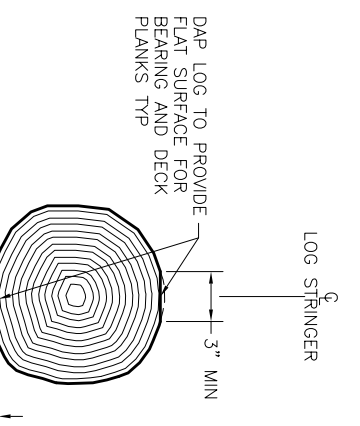

**LOG STRINGER DAPPING**  
SCALE: 1" = 1'-0"

MAXIMUM DEPTH OF DAP SHALL NOT EXCEED 10% OF LOG DIAMETER OR 2"

**TABLE-1 ROUND LOG STRINGER PEELLED SIZE MID SPAN DIAMETER REQUIREMENTS**

TIMBER SPECIES - DOUGLAS FIR (COASTAL OR INTERIOR NORTH) AND WESTERN LARCH

DESIGN LOADING IN POUNDS PER SQUARE FOOT

| STRINGER SPAN (FEET) | PEDESTRIAN LOAD | GROUND SNOW LOAD |
|----------------------|-----------------|------------------|
| 10                   | 65              | 85               |
| 15                   | 8"              | 8"               |
| 20                   | 9"              | 9"               |
| 25                   | 11"             | 11"              |
| 30                   | 12"             | 12"              |
| 35                   | 13"             | 13"              |
| 40                   | 14"             | 14"              |
| 45                   | 15"             | 15"              |

THE MINIMUM STRINGER DIAMETER FOR BRIDGES WITH PEDESTRIAN RAILS SHALL BE 11". BRIDGES WITH STRINGER DIAMETERS LESS THAN 11" SHALL HAVE CURBS ONLY. REFER TO SHEET 3 FOR CURB DETAILS.

**APPROVED:** \_\_\_\_\_ DATE \_\_\_\_\_

FOREST ENGINEER

**DWG NO.** \_\_\_\_\_

**SHEET 2 of 4 DESIGN AID RA840**

**DO NOT REDUCED-SCALE DRAWING**

U.S. DEPARTMENT OF AGRICULTURE  
**FOREST SERVICE**  
THE PACIFIC NORTHWEST REGION (R-6)

LOG STRINGER  
10 FT - 45 FT LONG  
TRAIL BRIDGE

| REV. | DESCRIPTION                             | APPROVED | DATE    |
|------|---|----------|---------|
| Δ    | DELETED (MIN NUMBER OF STRINGERS IS 3)  | MOE      | 9/13/05 |
| Δ    | REVISED TO R-6 STRUCTURES CAD STANDARDS | MOE      | 3/24/05 |

Forest Bridge No.: \_\_\_\_\_  
Location: \_\_\_\_\_  
Designed: \_\_\_\_\_  
Drawn: \_\_\_\_\_  
Checked: \_\_\_\_\_  
Approved: \_\_\_\_\_  
Date: 03/01/2004