

# Recreation Opportunity Guide



## SALMON LAKE CABIN

**DESCRIPTION:** This historic cabin was built around 1940, rehabilitated in 1969, and again in 1995. It is a 15' x 20', single story, single room structure with a gabled roof, built entirely of cedar. The hand hewn beams, wooden door hinges, and shake floor all combine to make a uniquely attractive wilderness cabin. Sleeps up to four people.



**LOCATION:** The cabin is in the Karta River Wilderness on the central portion of Prince of Wales Island. It sits on the north shore of Salmon Lake 42 air-miles northwest of Ketchikan. Refer to USGS topo maps Craig C-2 and C-3. Longitude: -132.67; Latitude: 55.58388889

**ACCESS:** The cabin is accessible by float plane or a trail (rated "More Difficult") five miles from saltwater. Occasionally poor weather may result in extended stays, and cabin users should be prepared for this. In fall, winter, and early spring, the cabin may be inaccessible due to frozen lake surface (float planes cannot land).

**TERRAIN:** The cabin sits at 118-foot elevation with gently sloping terrain. It has a sandy beach in front and is surrounded predominantly by cedar.

**SPECIAL FEATURES:** The primary attraction of this site is fishing for cutthroat, rainbow, and dolly varden. Salmon species found here include pink, silver, and sockeye. Swimming and beach activities are feasible during the warmer summer months from the large sandy beach just in front of the cabin. There is a 5-mile trail that connects Salmon Lake to Karta Bay. Hiking to McGilvery Creek and/or Anderson Creek (good fishing streams) is possible, but there are no developed trails.

### FACILITIES:

- Four single-size sleeping spaces
- Wood stove
- Cooking counter, table, shelves, and cupboard space
- Ax/maul/splitting wedges
- Broom
- 14' aluminum skiff with oars - flotation devices NOT provided
- A natural water source is Salmon Lake

- \*TREAT OR BOIL WATER BEFORE DRINKING.
- \*BRING YOUR OWN - sleeping bags, sleeping pads, cooking stove, lantern, pots, pans, plates, utensils, food, toilet paper, garbage bags, and fire starter.
- \*WOOD SUPPLY cannot be guaranteed. Please be conservative with wood and use only for heating purposes.

**CABIN LAYOUT:** There may be slight variations.

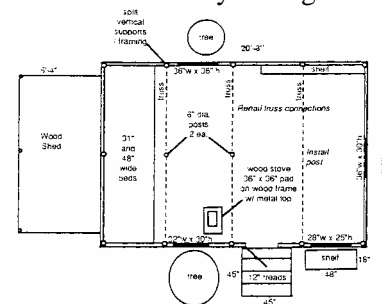

### RESERVATIONS ARE REQUIRED



Rental Fee: \$35/night May 1-Sept 30  
\$25/night Oct 1-Apr 30



Internet: [www.Recreation.gov](http://www.Recreation.gov)



Call (toll free) 1-877-444-6777



Visit Craig or Thorne Bay district offices for same-day or advance reservations.



USDA Forest Service  
Alaska Region  
Tongass National Forest

Thorne Bay Ranger District  
P.O. Box 19001, Thorne Bay, AK 99919  
(907) 828-3304

CABIN  
T-10/1887  
2007

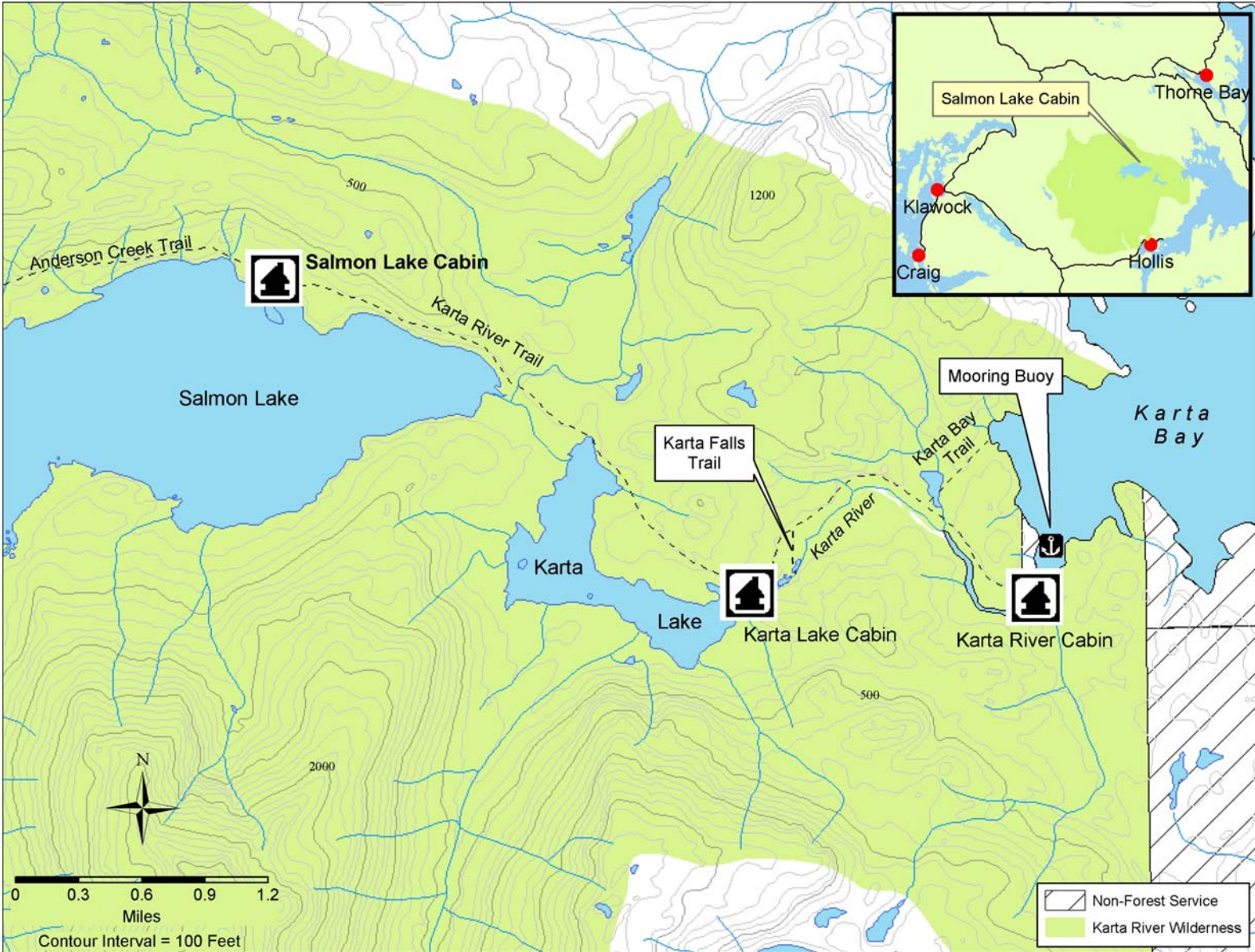

The Forest Service cannot assure the reliability or suitability of this information for a particular purpose. Original data was compiled from various sources and is the most current data available. Spatial information may not meet National Map Accuracy Standards. This information may be updated, corrected, or otherwise modified without notification. For additional information about this data, contact Tongass National Forest, Thorne Bay Ranger District Office.

**Plan ahead and prepare**  
**Pack it in, pack it out**  
**Leave what you find**



**Minimize campfire impacts**  
**Be considerate of others**  
**Respect wildlife**