

**LIGHTING SCIENCES INC.**  
 7830 E. EVANS RD. SCOTTSDALE, AZ. 85260 602-991-9260

CERTIFIED TEST REPORT NO. 2796 COMPUTED BY LSI PROGRAM \*\*TEST-LITE\*\*  
 GLOBE 20 IN. X 4 FT. RECESSED TROFFER, CAT NO. ALP9032-4R-05-12  
 12 CELL SEMI-SPECULAR LOUVER, ADVANCE BALLAST #R-240-TP  
 TWO F40LW/RS/WMI FLOURESCENT LAMPS. LUMEN RATING = 3050 LMS.

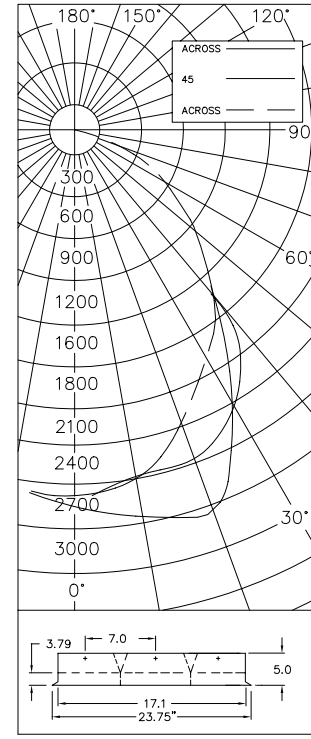
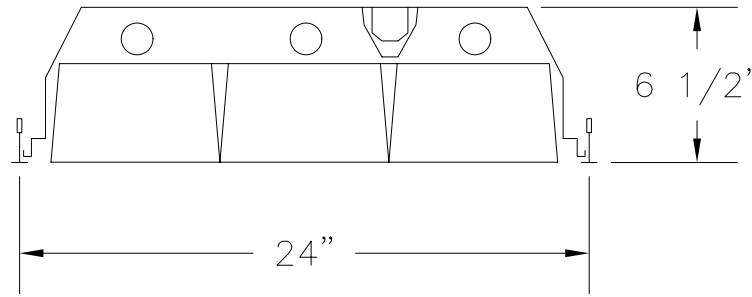

CANDLEPOWER SUMMARY						OUTPUT LUMENS
ANGLE	ACROSS	67.5	45	22.5	ALONG	
0	2509	2509	2509	2509	2509	
5	2506	2495	2484	2475	2470	237
10	2533	2506	2458	2419	2406	
15	2584	2523	2423	2342	2336	692
20	2688	2592	2411	2281	2234	
25	2687	2560	2341	2141	2068	1097
30	2745	2599	2330	2064	1960	
35	2515	2468	2303	1983	1846	1373
40	1971	2003	2123	1818	1639	
45	1542	1519	1774	1648	1482	1745
50	1203	1165	1295	1446	1202	
55	943	900	913	1128	920	840
60	663	579	323	620	560	
65	199	237	113	238	253	253
70	71	76	78	83	80	
75	38	41	42	43	41	48
80	19	20	20	19	19	
85	7	6	6	5	5	9
90	0	0	0	0	0	

ZONAL LUMENS AND PERCENTAGES			
0-30	2026	21.11	34.98
0-40	3399	35.41	58.68
0-60	5484	57.13	94.67
0-90	5793	60.35	100.00
40-90	2393	24.94	41.32
60-90	308	3.22	5.33
90-180	0	0.00	0.00
0-180	5793	60.35	100.00

\*\* EFFICIENCY = 60.35% \*\*  
 PAINT REFLECTANCE = .87 5/MH = 1.47  
 SC(ALONG) = 1.2, SC(ACROSS) = 1.6  
 CERTIFIED BY:  
 JON LEWIS DATE JUL 08, 1977  
 PREPARED FOR:  
 GLOBE ILLUMINATION  
 GARDENA, CA.  
 SHEILDING ANGLE: 32° C - 30° L

LUMINANCE SUMMARY-FOOTLAMBERTS						
ANGLE	ACROSS			ALONG		
	AVG	MAX	M/A	AVG	MAX	M/A
45	1047	2332	2.2	968	2789	2.9
55	789	1646	2.1	768	2583	3.4
65	227	1074	4.7	286	617	2.2
75	71	72	1.0	76	91	1.2
85	37	64	1.7	30	55	1.8

TESTED IN ACCORDANCE WITH IES PROCEDURES. TEST DISTANCE = 8 METERS (26')

COEFFICIENTS OF UTILIZATION  
 EFFECTIVE FLOOR CAVITY REFLECTANCE = .20

ROOM CAVITY RATIO	CC		80				70				50				30				10				0						
	WALL		70	50	30	10	70	50	30	10	50	30	10	50	30	10	50	30	10	50	30	10	50	30	10	50	30	10	
1			.67	.65	.63	.62	.66	.64	.62	.61	.62	.60	.59	.59	.58	.57	.57	.56	.55	.54									
2			.63	.59	.56	.54	.62	.58	.55	.53	.56	.54	.52	.54	.52	.51	.53	.51	.50	.50									
3			.58	.54	.50	.47	.57	.53	.49	.46	.51	.49	.46	.50	.47	.45	.49	.46	.44	.43									
4			.54	.48	.44	.41	.53	.48	.44	.41	.46	.43	.40	.43	.42	.40	.44	.41	.39	.38									
5			.50	.44	.39	.36	.49	.43	.39	.35	.42	.38	.35	.41	.37	.35	.40	.37	.34	.33									
6			.47	.39	.35	.32	.43	.39	.34	.31	.38	.34	.31	.37	.33	.31	.36	.33	.30	.29									
7			.43	.36	.31	.28	.42	.35	.31	.27	.34	.30	.27	.33	.30	.27	.33	.29	.27	.26									
8			.40	.32	.27	.24	.39	.31	.27	.24	.32	.27	.24	.30	.26	.24	.29	.26	.24	.22									
9			.36	.29	.24	.21	.36	.28	.24	.21	.28	.24	.21	.27	.23	.21	.26	.23	.20	.19									
10			.34	.26	.21	.18	.33	.26	.22	.18	.25	.21	.18	.25	.21	.18	.24	.21	.18	.17									

3 TUBE PARABOLIC TYPE LUMINARE  
 APPROVED FOR RECESSED MOUNTING

THE LUMINARE SHALL BE COMMERCIAL TYPE WITH CODE GAUGE MULTIPLE-DIE FORMED STEEL, COLD ROLLED STEEL HOUSING. COVER PLATE FOR DUCT OPENING PROVIDED.

LOUVER ASSEMBLY TO BE PROVIDED WITH SELF-ALIGNING SPRING LOADED TRIGGER LATCHES AND HEAVY GAUGE STEEL HINGES WHICH ALLOW HINGING FROM EITHER SIDE. PAINTED METAL PARTS ARE PRIMED WITH A COATING OF IRON PHOSPHATE. THE REGRESS AREA IS PAINTED, BAKED MATTE BLACK ENAMEL, LOUVERS ARE TO BE PRE-ANODIZED SEMI-SPECULAR ALUMINUM.

THE COEFFICIENT OF UTILIZATION SHALL NOT BE LESS THAN .38 BASED ON A CEILING REFLECTANCE OF 50 PERCENT, WALL REFLECTANCE OF 30 PERCENT, FLOOR REFLECTANCE OF 20 PERCENT, AND A ROOM CAVITY RATIO OF 5.

BALLAST SHALL BE ENERGY SAVING, HPF, ETL, 430MA WITH U.L. AND C.B.M. LABELS. VOLTAGE TO BE SHOWN ON DRAWINGS. FIXTURE TO BE GLOBE CAT. NO ALP8243-4R-05-18.

LAMPS  
 BALLAST

F-56  
 10-24-88

3-4 FOOT-F-40 T12 CW  
 RAPID START